

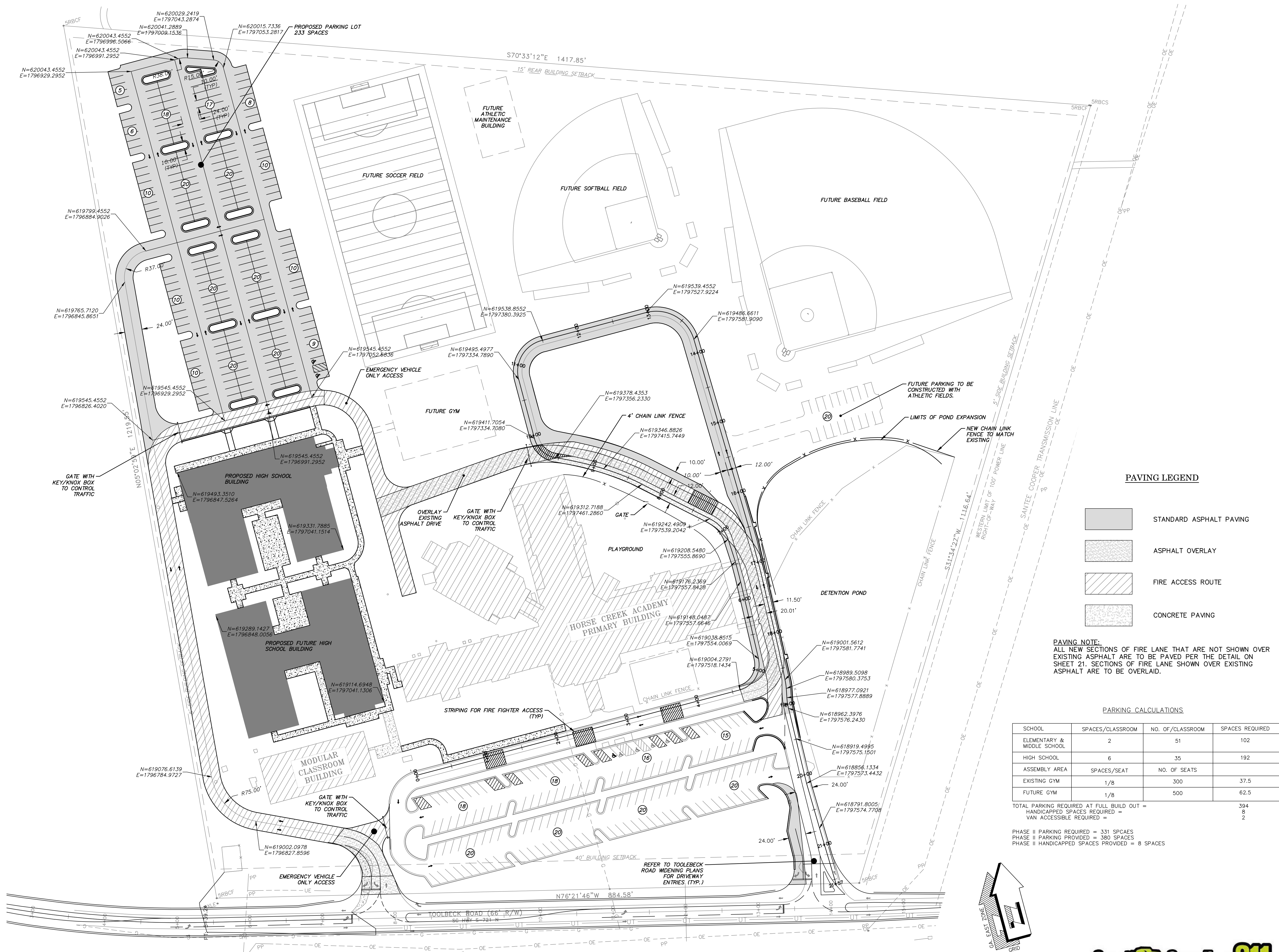



G:\AAA-ACTIVE JOBS\2020-0459_HORSE CREEK ACADEMY - PHASE 2 SITE IMPROVEMENTS.AAA - DRAWINGS\CIVIL\2020-0459-SS_OV.DWG 12/18/2020 5:54 PM



PAVING LEGEND

-  STANDARD ASPHALT PAVING
-  ASPHALT OVERLAY
-  FIRE ACCESS ROUTE
-  CONCRETE PAVING

PAVING NOTE:
 ALL NEW SECTIONS OF FIRE LANE THAT ARE NOT SHOWN OVER EXISTING ASPHALT ARE TO BE PAVED PER THE DETAIL ON SHEET 21. SECTIONS OF FIRE LANE SHOWN OVER EXISTING ASPHALT ARE TO BE OVERLAID.

PARKING CALCULATIONS

SCHOOL	SPACES/CLASSROOM	NO. OF CLASSROOM	SPACES REQUIRED
ELEMENTARY & MIDDLE SCHOOL	2	51	102
HIGH SCHOOL	6	35	192
ASSEMBLY AREA	SPACES/SEAT	NO. OF SEATS	
EXISTING GYM	1/8	300	37.5
FUTURE GYM	1/8	500	62.5

TOTAL PARKING REQUIRED AT FULL BUILD OUT = 394
 HANDICAPPED SPACES REQUIRED = 8
 VAN ACCESSIBLE REQUIRED = 2

PHASE II PARKING REQUIRED = 331 SPAES
 PHASE II PARKING PROVIDED = 380 SPACES
 PHASE II HANDICAPPED SPACES PROVIDED = 8 SPACES



CRANSTON
 ENGINEERING
 ENGINEERS - PLANNERS - SURVEYORS
 452 Ellis Street, Augusta, Georgia 30901
 Telephone 706-722-1588
 CranstonEngineering.com

SOUTH CAROLINA
 LICENSED PROFESSIONAL ENGINEER
 NO. 23030
 DENNIS J. WELCH

PRELIMINARY
 NOT FOR CONSTRUCTION

SOUTH CAROLINA
 Cranston Engineering Group
 NO. C00575
 CERTIFICATE OF AUTHORIZATION

REV #	DATE	DESCRIPTION

Horse Creek Academy
Phase 2 Site Improvements

SITE PLAN

DRAWN BY:	GSA
CHECKED BY:	BSF
APPROVED BY:	DJW
DATE:	DECEMBER 23, 2020
SCALE:	1" = 60'
JOB No.	2020-0459
DRAWING No.	